



Designer ceilings | Wall absorbers
OWAconsult collection

www.owa-ceilings.com

Content

| | | |
|----|--|--|
| 04 | | OWAconsult collection product world |
| 06 | | Wall absorber - Selecta |
| 14 | | Wall absorber - Creaprint |
| 22 | | Wall absorber - Curve |
| 28 | | Wall absorber - FreeStyle |
| 36 | | Wall absorber - Corpus |
| 44 | | Magnetic wall absorber - OWAtecta S 60 |
| 51 | | Sound absorption figures overview |
| 52 | | OWAcolour - fabric colour options |

Variety of shapes and colours

OWAconsult collection product world Wall absorbers

Sophisticated aesthetics, acoustic harmony and functional elegance. The wall absorbers of the OWAconsult collection combine the latest technology with the highest acoustic requirements and completely reinvent room design.

Fixing them to the wall opens up completely new design possibilities with maximum acoustic effectiveness. The wall absorbers can be ordered in various colours, allowing them to be effortlessly integrated into existing design concepts and ensuring a harmonious balance between form and function.



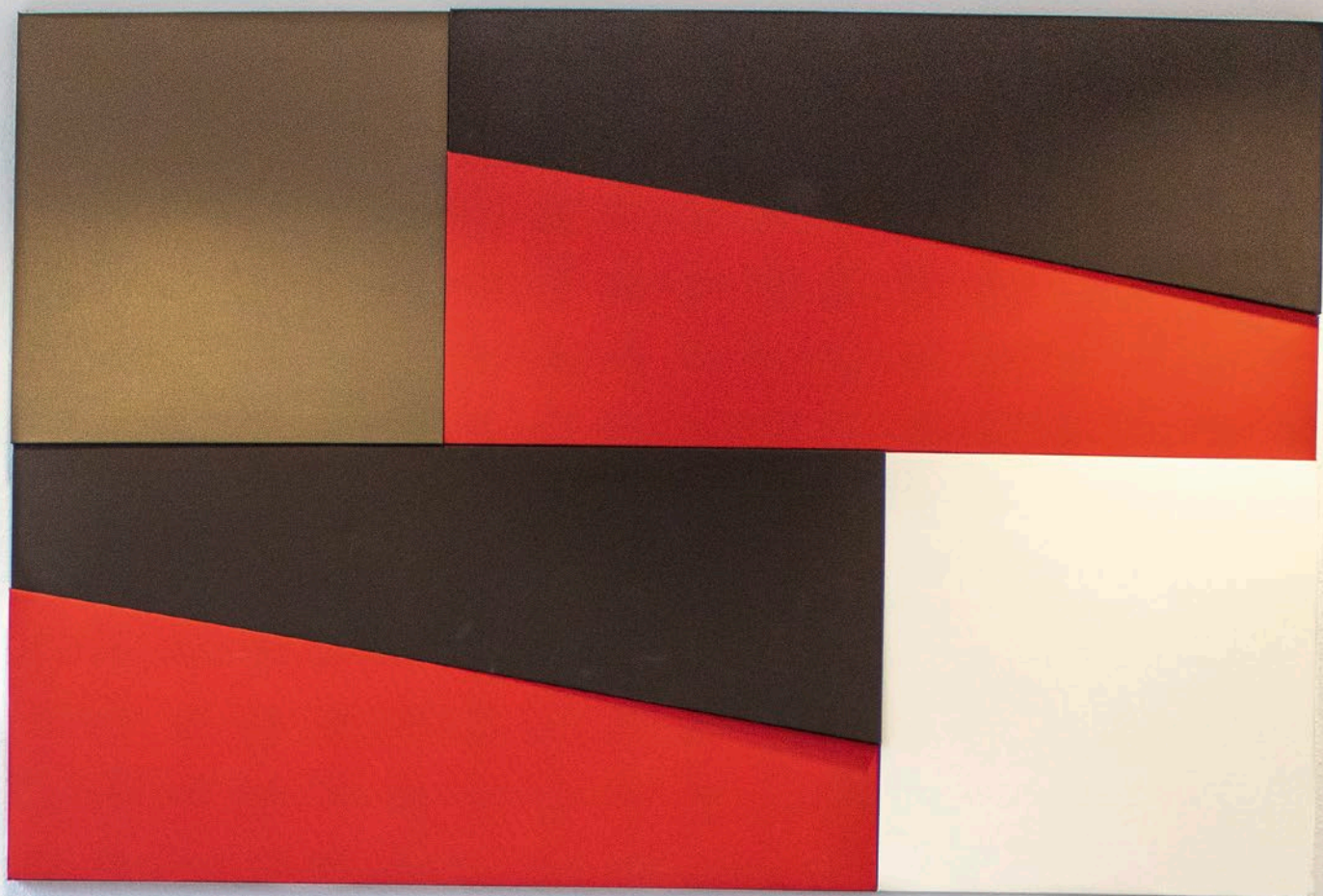



PRODUCT: Wall absorber – Selecta
PROJECT: Office building
REGION: Braunschweig, Germany

Wall absorber **Selecta**

Geometry of the exclusive Selecta

Do you associate design consciousness with strong acoustic demands of your working environment? Then choose Selecta, an exclusive range of lightweight glass wool absorbers in Class A format (sound absorption value α_w - 0.90). There is a choice of five distinctive, white fleece covered basic shapes. The various sized wall absorbers are fixed to the wall, using wall claws. Selecta offers many creative acoustic solutions for practically every interior environment.



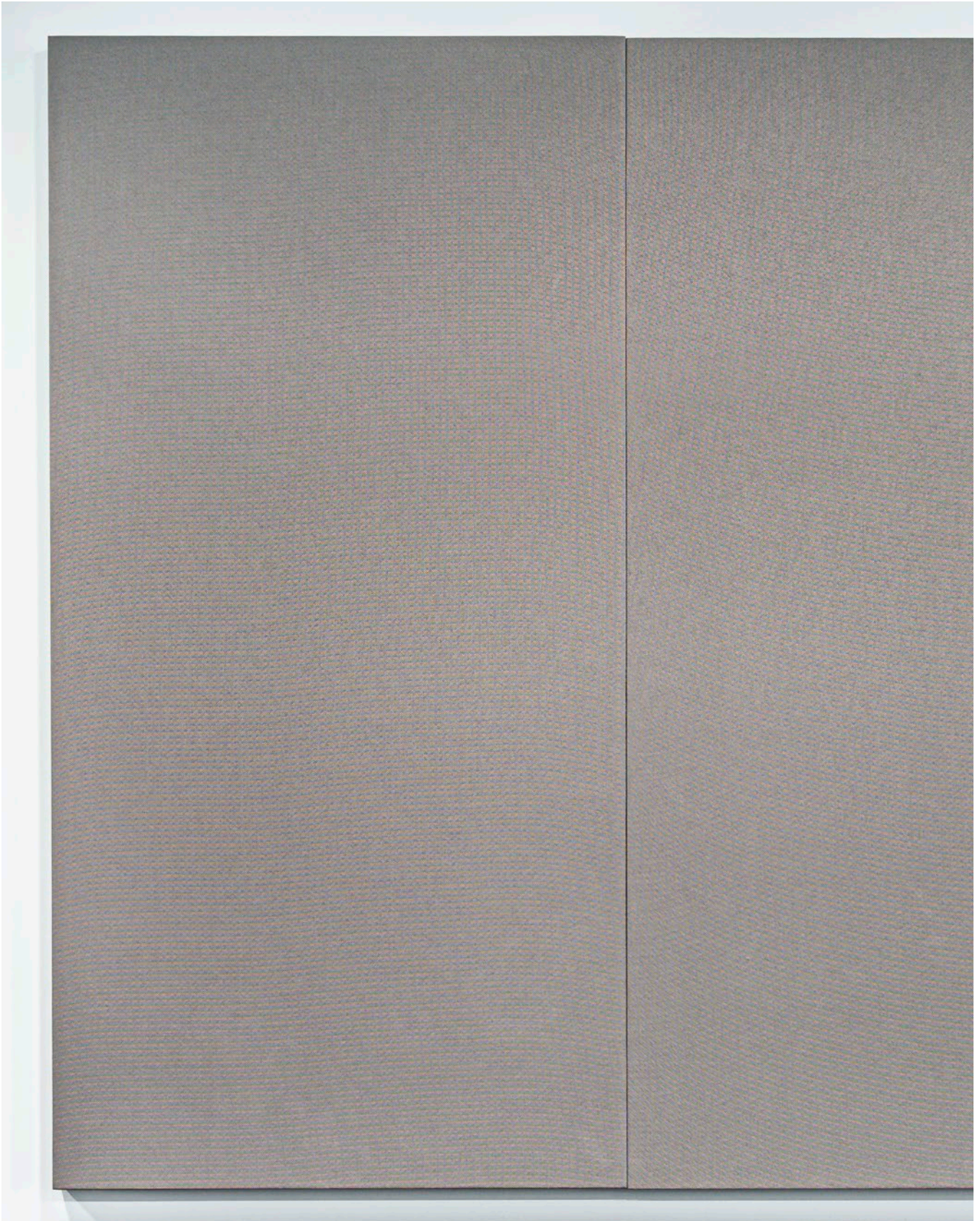

PRODUCT: Wall absorber – Selecta
PROJECT: Office building
REGION: Braunschweig, Germany

Selecta one, plus, grande, loop

**Selecta one
white fleece**

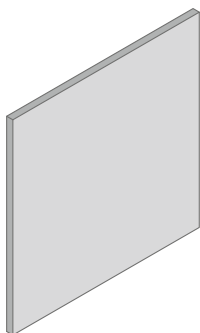

**Selecta plus
white fleece**



**Selecta grande
white fleece**



**Selecta grande XL
white fleece**



**Selecta loop
white fleece**

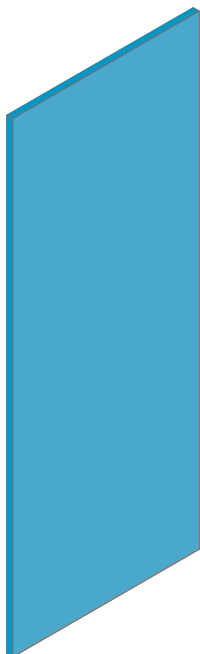

**Selecta grande XL
coloured fabric**



**Selecta grande
coloured fabric**



**Selecta plus
coloured fabric**



**Selecta one
coloured fabric**



**Selecta loop
coloured fabric**

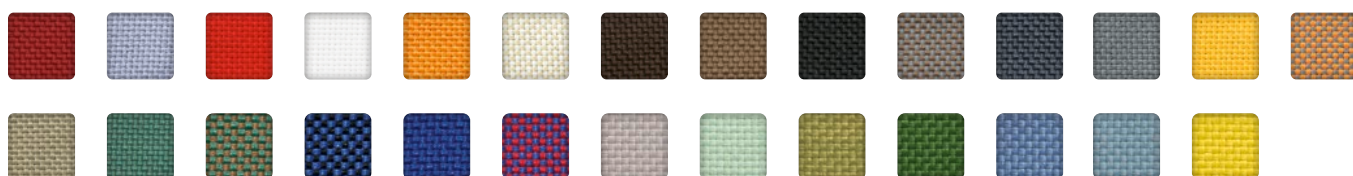

For more information of the OWAcOLOR world of colours see page 52.

For more information on articles and prices, please see the [OWAconsult collection price list 1001 e.](#)

Selecta one, plus, grande, loop

Selecta one, plus, grande, grande XL

| | Length | Width | Thickness | Visible side | Weight | Part no. |
|-------------------|---------|---------|-----------|-----------------|-----------------|------------|
| Selecta one | 1200 mm | 1200 mm | 40 mm | white fleece | approx. 6.2 kg | 00074782 |
| Selecta one | 1200 mm | 1200 mm | 40 mm | coloured fabric | approx. 6.2 kg | on request |
| Selecta plus | 1800 mm | 1200 mm | 40 mm | white fleece | approx. 9.3 kg | 00074783 |
| Selecta plus | 1800 mm | 1200 mm | 40 mm | coloured fabric | approx. 9.3 kg | on request |
| Selecta grande | 2400 mm | 1200 mm | 40 mm | white fleece | approx. 12.4 kg | 00074780 |
| Selecta grande | 2400 mm | 1200 mm | 40 mm | coloured fabric | approx. 12.4 kg | on request |
| Selecta grande XL | 3000 mm | 1200 mm | 40 mm | white fleece | approx. 15.5 kg | 00092154 |
| Selecta grande XL | 3000 mm | 1200 mm | 40 mm | coloured fabric | approx. 15.5 kg | on request |

The price includes the installation set. | Packing unit for all wall absorbers: 1 piece per parcel

See [OWAconsult collection price list 1001 e](#) | Special formats/special shapes on request.

Minimum quantity surcharge of 350.00 €/call for orders of special formats/special shapes less than 35 pieces, part no. 00076116

Selecta loop

| | Diameter | Thickness | Visible side | Weight | Part no. |
|--------------|-----------|-----------|-----------------|----------------|------------|
| Selecta loop | Ø 800 mm | 40 mm | white fleece | approx. 2.2 kg | 00077120 |
| Selecta loop | Ø 800 mm | 40 mm | coloured fabric | approx. 2.2 kg | on request |
| Selecta loop | Ø 1000 mm | 40 mm | white fleece | approx. 3.4 kg | 00077180 |
| Selecta loop | Ø 1000 mm | 40 mm | coloured fabric | approx. 3.4 kg | on request |
| Selecta loop | Ø 1200 mm | 40 mm | white fleece | approx. 4.9 kg | 00074781 |
| Selecta loop | Ø 1200 mm | 40 mm | coloured fabric | approx. 4.9 kg | on request |

The price includes the installation set. | Packing unit for all wall absorbers: 1 piece per parcel

See [OWAconsult collection price list 1001 e](#) | Special formats/special shapes on request.

Minimum quantity surcharge of 350.00 €/call for orders of special formats/special shapes less than 35 pieces, part no. 00076116

Our service excellence team will be happy to assist you with any other special formats and shapes.

Technical data at a glance



* Valid only for white fleece

| | |
|--|--|
| Visible side | White fleece, coloured fabric |
| Edges | White fleece, coloured fabric |
| Edge detail | Straight edges, all the way round |
| Reaction to fire for white fleece | A2-s1,d0 in accordance with EN 13501-1 |
| Grid suspension | Inclusive packing unit for wall installation |
| Sound absorption | Sound absorption values, see page 51 |
| Humidity resistance | Up to 90 % RH |

Installation accessories – Selecta

Installation accessories for Selecta one/plus

| Component description | Part no. |
|---------------------------------|----------|
| Set contains: 4 pcs. wall claws | 00073602 |

Please order one fitting set per wall absorber. **The price includes the installation set.**

Installation accessories for Selecta grande

| Component description | Part no. |
|---------------------------------|----------|
| Set contains: 6 pcs. wall claws | 00073603 |

Please order one fitting set per wall absorber. **The price includes the installation set.**

Installation accessories for Selecta grande XL

| Component description | Part no. |
|---|----------|
| 2 x Set for Selecta one/plus contains 4 wall claws each | 00073602 |

Please order one fitting set per wall absorber. **The price includes the installation set.**

Installation accessories for Selecta loop

| Component description | Part no. |
|--|----------|
| Set contains: 6 pcs. wall claws for 2 Selecta loop | 00073603 |

Please order one fitting set per wall absorber. **The price includes the installation set.**



Wall claw 88 x 52 x 1.0 mm, barbs 35 mm long

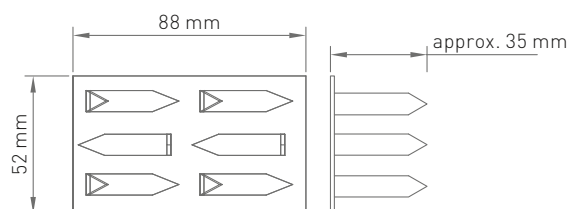

Wall installation – Selecta

1. Rear view of the wall absorbers:
Each wall absorber has markings on the rear in the form of a cross.

Selecta one

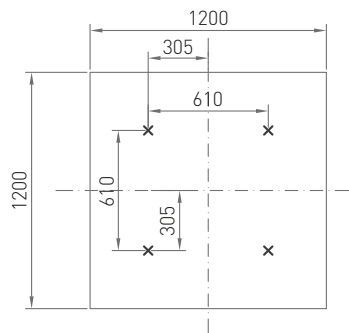

Selecta loop 1200

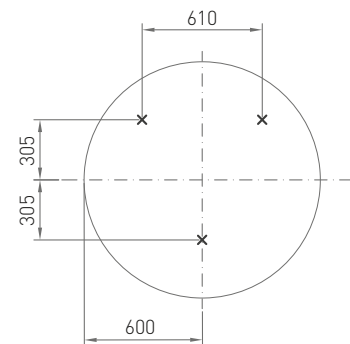

Selecta plus

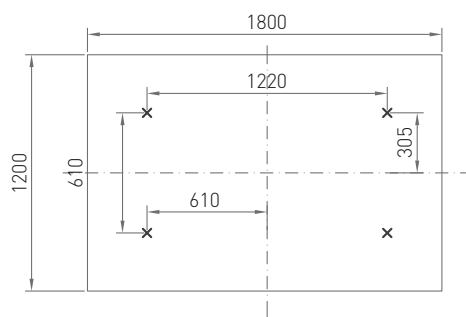

Selecta loop 1000

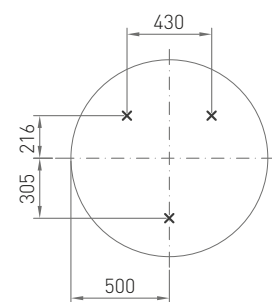

Selecta grande

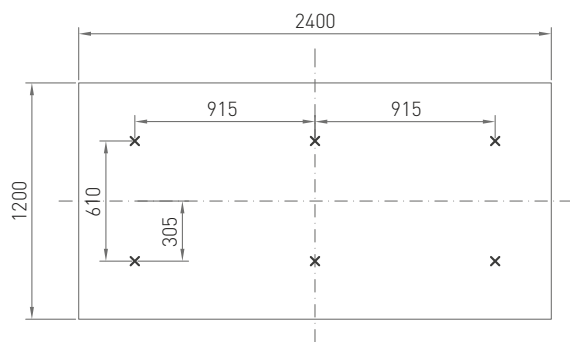

Selecta loop 800

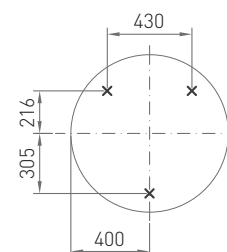

Selecta grande XL

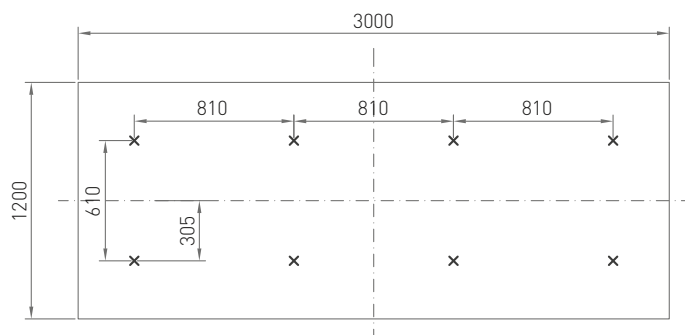

x = Marking for wall fixing

The distances between the fixing points must match the on-site anchor image on the wall.

Wall installation – Selecta

2. Level out any unevenness in the wall.
3. Measure and level the position of the wall claws according to the markings on the rear of the components.
4. Fasten wall claws with approved fixings according to the respective substrate.
5. Position the components on the wall claw and press on. Minor unevenness in the substrate can be evened out by applying different pressure.

If necessary, the components can be removed again and reinstalled at another location using the available wall claws.

Wall claws are **not** suitable for direct mounting on the ceiling!



Wall claw 88 x 52 x 1.0 mm, barbs 35 mm long

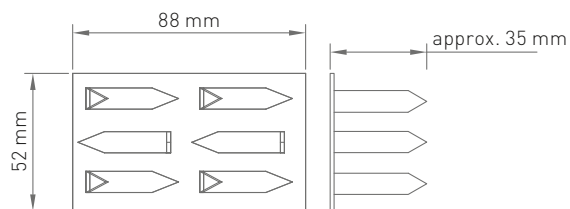



Wall absorber **Creaprint**

The perfect harmony of design and acoustics

Creaprint

Creaprint wall absorbers are effective acoustic absorbers and thus create an atmosphere that promotes communication and concentration in equal measure. Multiple wall absorbers can be combined to create effective designs. The different surface sizes offer scope for your creativity and can be attached to the wall in a wide variety of configurations.



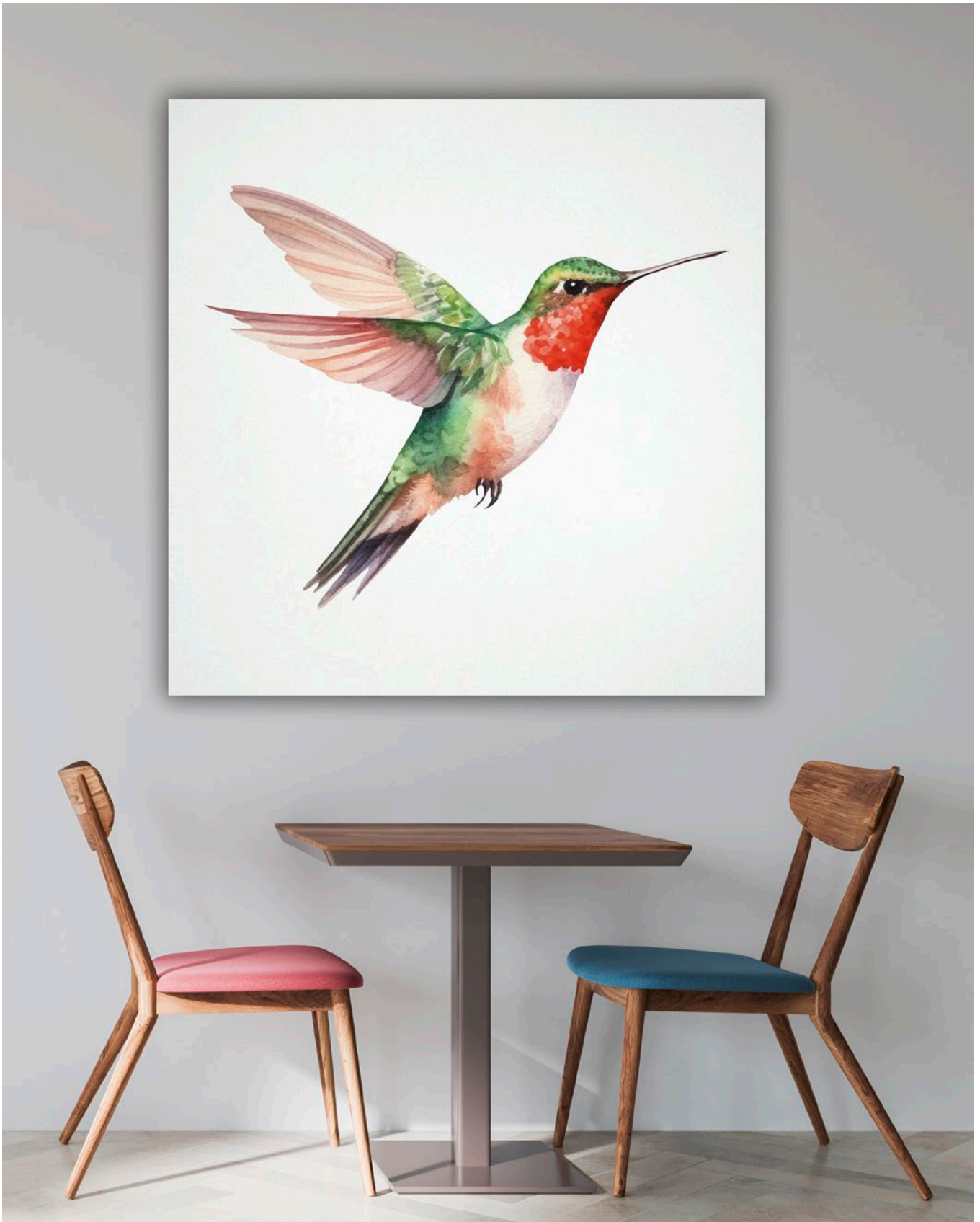

PRODUCT: Visualisation wall absorber – Creaprint

Creaprint one, plus, grande

**Creaprint wall absorber one
white fleece**

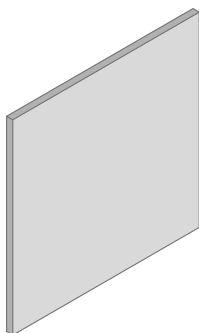

**Creaprint wall absorber plus
white fleece**



**Creaprint wall absorber grande
white fleece**



Custom design.
Fully printed visible surface, edges: white.

Creaprint

Creaprint

| | Length | Width | Thickness | Visible side | Weight | Part no. |
|------------------|---------|---------|-----------|--------------|-----------------|----------|
| Creaprint one | 1200 mm | 1200 mm | 40 mm | white fleece | approx. 6.2 kg | 00091111 |
| Creaprint plus | 1800 mm | 1200 mm | 40 mm | white fleece | approx. 9.3 kg | 00091264 |
| Creaprint grande | 2400 mm | 1200 mm | 40 mm | white fleece | approx. 12.4 kg | 00091265 |

Custom design | Fully printed visible surface, edges: white

The price includes the installation set. | Packing unit for all wall absorbers: 1 piece per parcel

See [OWAconsult collection price list 1001 e](#) | Special formats/special shapes on request.

Minimum quantity surcharge of 350.00 €/call for orders of special formats/special shapes less than 35 pieces, part no. 00076116

Our service excellence team will be happy to assist you with any other special formats and shapes.

Technical data at a glance



* Valid only for white fleece

| | |
|--|--|
| Visible side | Custom printed image |
| Edges | White edges |
| Edge detail | Straight edges, all the way round |
| Reaction to fire for white fleece | A2-s1,d0 in accordance with EN 13501-1 |
| Grid suspension | Inclusive packing unit for wall installation |
| Sound absorption | Sound absorption values, see page 51 |
| Humidity resistance | Up to 90 % RH |

Installation accessories – Creaprint

Installation accessories for Creaprint one/plus

| Component description | Part no. |
|---------------------------------|----------|
| Set contains: 4 pcs. wall claws | 00073602 |

Please order one fitting set per wall absorber. **The price includes the installation set.**

Installation accessories for Creaprint grande

| Component description | Part no. |
|---------------------------------|----------|
| Set contains: 6 pcs. wall claws | 00073603 |

Please order one fitting set per wall absorber. **The price includes the installation set.**



Wall claw 88 x 52 x 1.0 mm, barbs 35 mm long

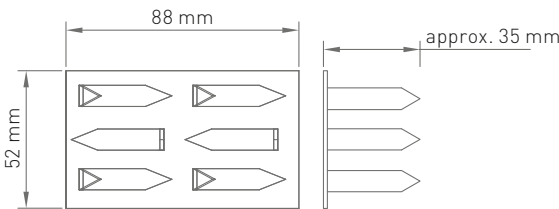

Wall installation– Creaprint

1. Rear view of the wall absorbers:
Each wall absorber has markings on the rear in the form of a cross.

Creaprint one

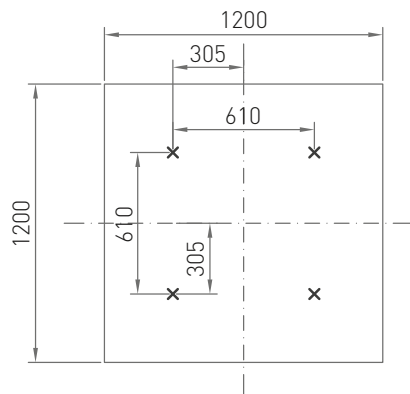

Creaprint plus

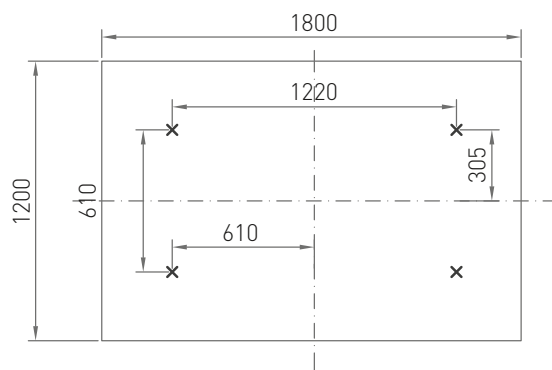

Creaprint grande

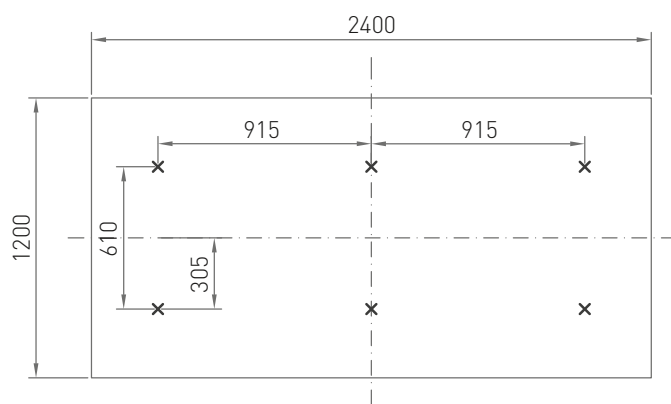

x = Marking for wall fixing

The distances between the fixing points must match the on-site anchor image on the wall.

Wall installation – Creaprint

2. Level out any unevenness in the wall.
3. Measure and level the position of the wall claws according to the markings on the rear of the components.
4. Fasten wall claws with approved fixings according to the respective substrate.
5. Position the components on the wall claw and press on. Minor unevenness in the substrate can be evened out by applying different pressure.

If necessary, the components can be removed again and reinstalled at another location using the available wall claws.

Wall claws are **not** suitable for direct mounting on the ceiling!



Wall claw 88 x 52 x 1.0 mm, barbs 35 mm long

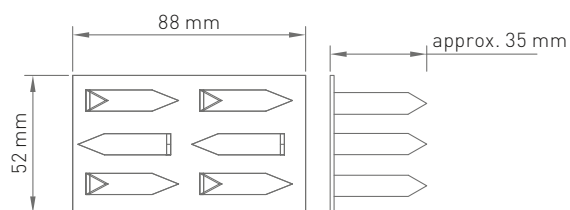



PRODUCT: Wall absorber – Curve
PROJECT: Odenwald Faserplattenwerk GmbH
REGION: Amorbach, Germany

Wall absorber **Curve**

So easy to get good room acoustics

Curve

Curve wall absorbers are made from glass wool and are therefore lightweight. The visible face and edges of both versions have white, finished surfaces. They can therefore be installed singly or in groups to create interesting formations. Strong acoustic plus: Curve is an A-class absorber (sound absorption values α_w - 0.90). The modules, available up to a size of 1200 x 1100 mm, can also be supplied in coloured fabric - for even more design freedom on the wall.



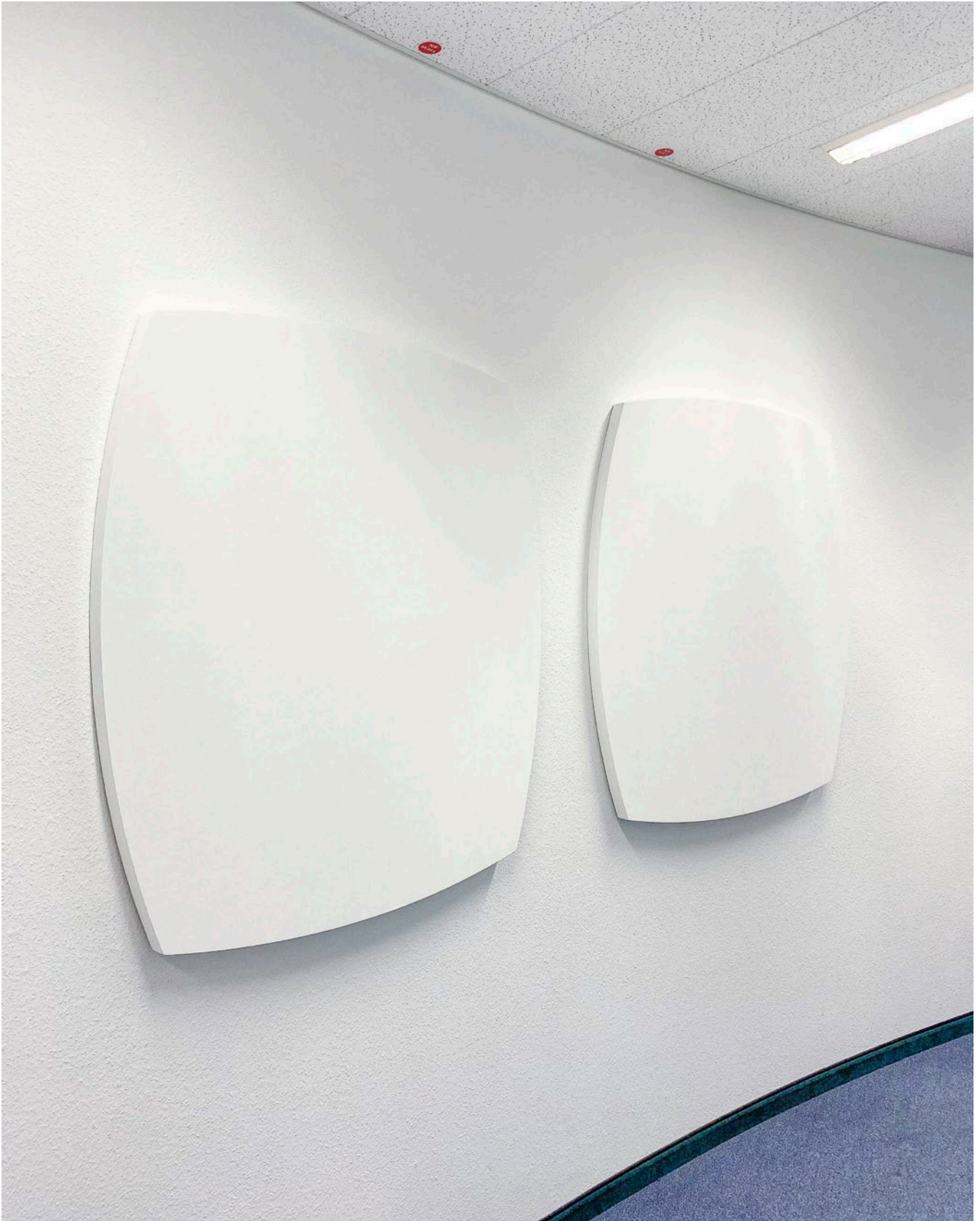

PRODUCT: Wall absorber – Curve
PROJECT: Odenwald Faserplattenwerk GmbH
REGION: Amorbach, Germany

Curve

Curve 1 white fleece

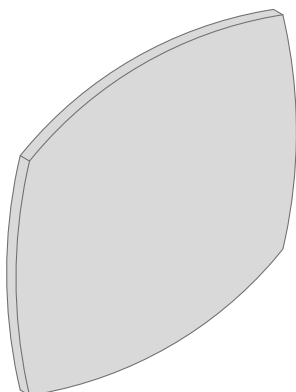

Curve 2 white fleece

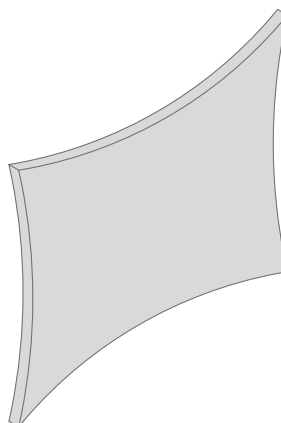

Curve 1 coloured fabric

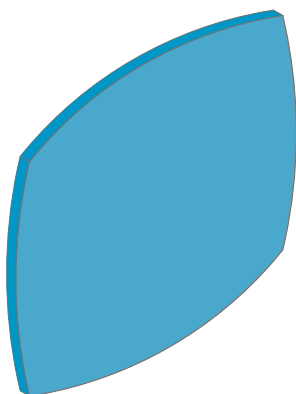

Curve 2 coloured fabric

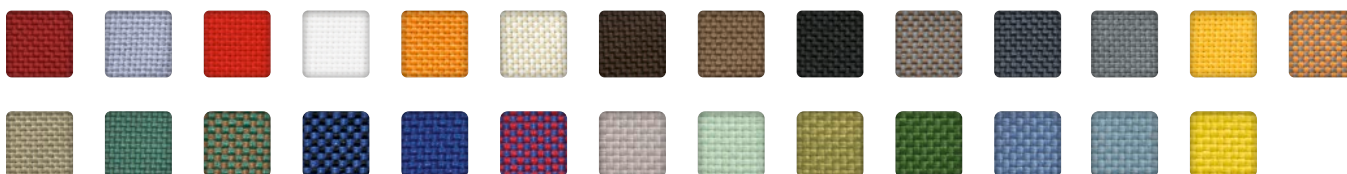
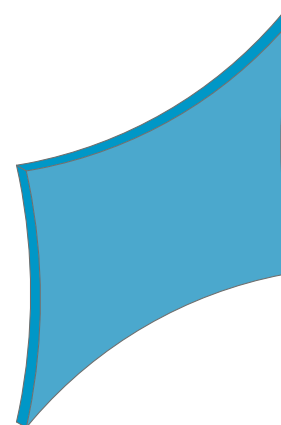

For more information of the OWAcolor world of colours see page 52.

For more information on articles and prices, please see the [OWAconsult collection price list 1001 e.](#)

Curve

Curve

| | Length | Width | Thickness | Visible side | Weight | Part no. |
|---------|---------|---------|-----------|-----------------|----------------|---------------------|
| Curve 1 | 1200 mm | 1100 mm | 40 mm | white fleece | approx. 5.3 kg | 00074785 |
| Curve 1 | 1200 mm | 1100 mm | 40 mm | coloured fabric | approx. 5.7 kg | depending on colour |
| Curve 2 | 1100 mm | 910 mm | 40 mm | white fleece | approx. 4.0 kg | 00074786 |
| Curve 2 | 1100 mm | 910 mm | 40 mm | coloured fabric | approx. 4.3 kg | depending on colour |

The price includes the installation set. | Packing unit for all wall absorbers: 1 piece per parcel
See [OWAconsult collection price list 1001 e.](#)

Installation accessories – Curve

| Component description | Part no. |
|---------------------------------|----------|
| Set contains: 4 pcs. wall claws | 00073602 |

Please order one fitting set per wall absorber. **The price includes the installation set.**



Wall claw 88 x 52 x 1.0 mm, barbs 35 mm long

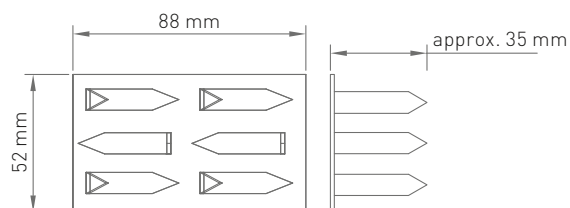

Technical data at a glance



* Valid only for white fleece

| | |
|--|--|
| Visible side | White fleece or coloured fabric |
| Edges | White fleece or coloured fabric |
| Edge detail | Straight edges, all the way round |
| Reaction to fire for white fleece | A2-s1,d0 in accordance with EN 13501-1 |
| Grid suspension | Inclusive packing unit for wall installation |
| Sound absorption | Sound absorption values, see page 51 |
| Humidity resistance | Up to 90 % RH |

Wall installation – Curve

1. Rear view of the wall absorbers:
Each wall absorber has markings on the rear in the form of a cross.

Curve 1

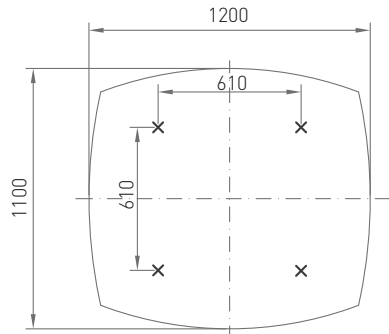

Curve 2

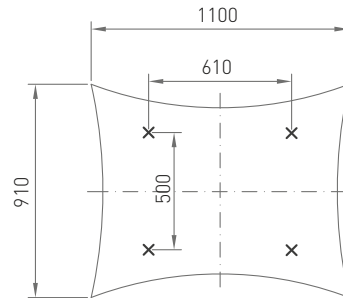

x = Wall claw fixing centres

The distances between the fixing points must match the on-site setting out on the wall.

2. Level out any unevenness in the wall.
3. Measure and level the position of the wall claws according to the markings on the rear of the components.
4. Fasten wall claws with approved fixings according to the respective substrate.
5. Position the components on the wall claw and press on. Minor unevenness in the substrate can be evened out by applying different pressure.

If necessary, the components can be removed again and reinstalled at another location using the available wall claws.

Wall claws are **not** suitable for direct mounting on the ceiling!



Wall claw 88 x 52 x 1.0 mm, barbs 35 mm long

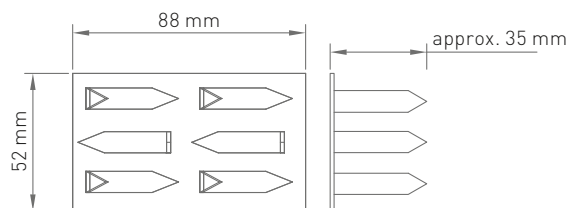



Wall absorber **FreeStyle**

Limitless freedom for your own style FreeStyle wall absorber

Numerous combination possibilities – good acoustics: With FreeStyle wall absorbers from OWA, it is possible to create individual, unique interior landscapes. In different sizes and shapes, they can transform any wall in the room into a 3D surface and that way literally create a “moving” room experience! The carefully colour-coordinated and geometrically-matched elements of the FreeStyle collection signify this high degree of individual design freedom. A special feature of the FreeStyle series is its good absorption capability. Noise and sounds are swallowed with an absorption level of up to 90 %. Good design comes together with effective control of reverberation, especially important in potentially noisy areas such as in restaurants and open-plan offices in order to realise good speech intelligibility.





PRODUCT: Visualisation FreeStyle wall absorber

FreeStyle

FreeStyle coloured fabric

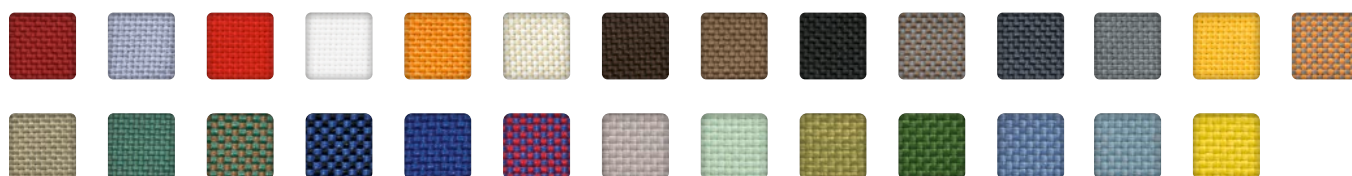
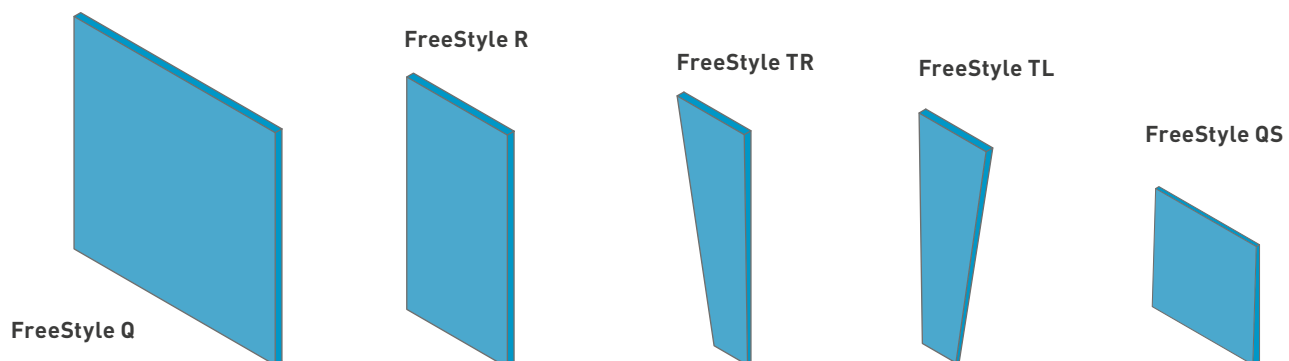

For more information of the OWAcolor world of colours see page 52.

For more information on articles and prices, please see the [OWAconsult collection price list 1001 e.](#)

FreeStyle

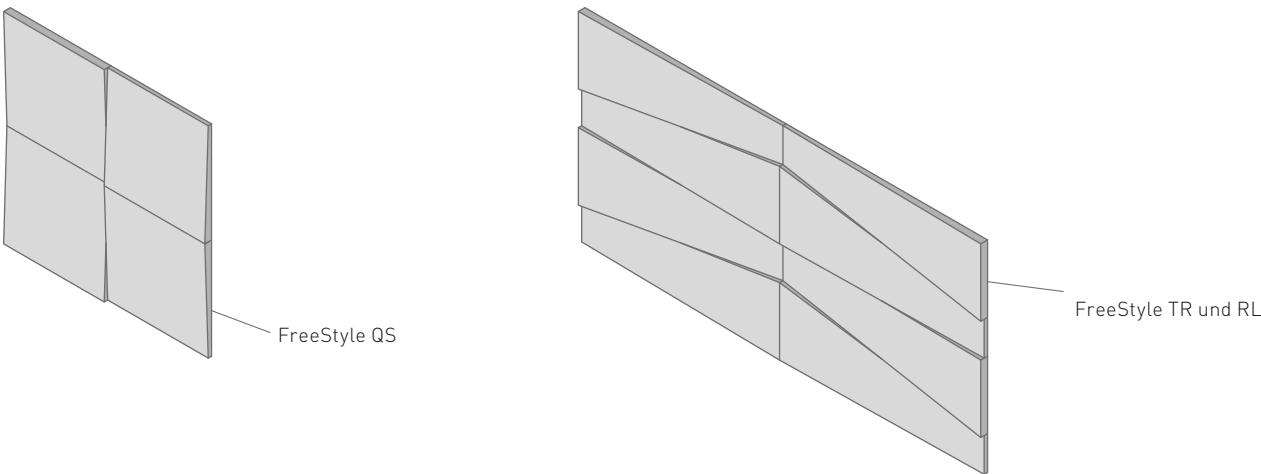

FreeStyle

| | Type | Length | Width | Thickness | Visible side | Weight | Units | Part no. |
|--------------|---------------|---------|------------|-----------|-----------------|--------|-------|------------|
| FreeStyle Q | | 1200 mm | 1200 mm | 40 mm | coloured fabric | 6.1 kg | 1 | on request |
| FreeStyle R | | 1200 mm | 600 mm | 40 mm | coloured fabric | 3.0 kg | 2 | on request |
| FreeStyle TR | Trapeze right | 1200 mm | 400/200 mm | 40/20 mm | coloured fabric | 1.2 kg | 4 | on request |
| FreeStyle TL | Trapeze left | 1200 mm | 400/200 mm | 40/20 mm | coloured fabric | 1.2 kg | 4 | on request |
| FreeStyle QS | | 600 mm | 600 mm | 40/20 mm | coloured fabric | 1.2 kg | 8 | on request |

The price includes the installation set. | See [OWAconsult collection price list 1001 e](#).
Special formats/special shapes on request.

Technical data at a glance

| | |
|---------------------|--|
| Visible side | Coloured fabric |
| Edges | Coloured fabric |
| Edge detail | Straight edges, all the way round |
| Grid suspension | Inclusive packing unit for wall installation |
| Sound absorption | Sound absorption values, see page 51 |
| Humidity resistance | Up to 90 % RH |

Installation accessories – FreeStyle

| Component description | Part no. |
|---|----------|
| Wall installation set of 4 pieces for FreeStyle Q and R; set contains 4 pieces of wall claws | 00073602 |
| Wall installation set of 4 pieces for FreeStyle TR, TL and QS set containing 2 pieces of wall claws 60 x 52 x 15 mm and 2 pieces of wall claws 88 x 52 x 35 mm | 00075611 |

Please order one fitting set per wall absorber. **The price includes the installation set.**



Wall claw for 40 mm strong wall absorber,
claw height 35 mm

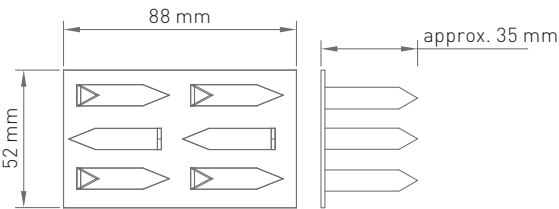

Wall claw for 40/20 mm strong wall absorber,
claw height 15 mm

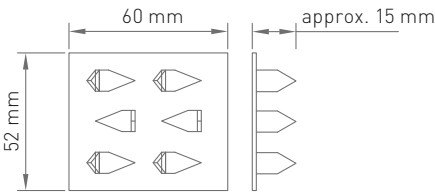

Wall installation – FreeStyle

1. Dimensions FreeStyle elements:

FreeStyle Q

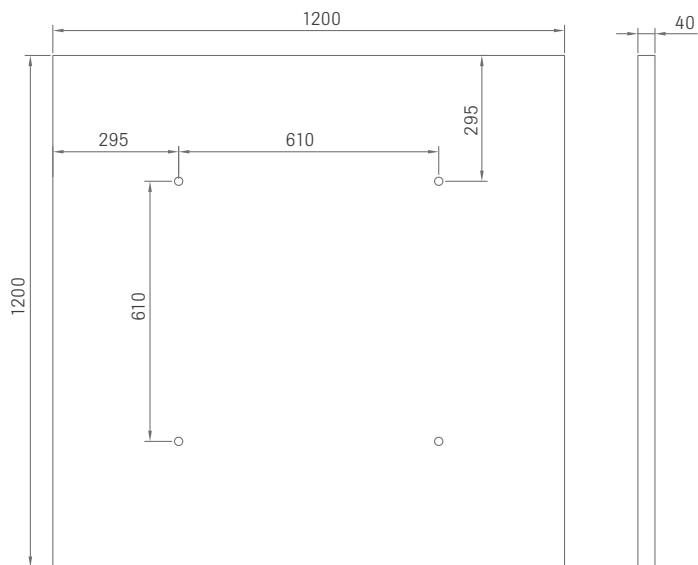

FreeStyle R

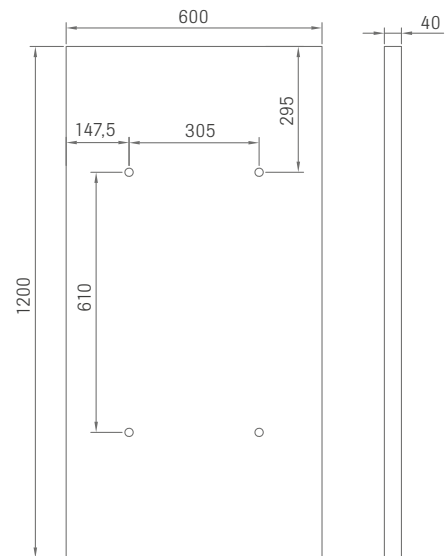

FreeStyle TL

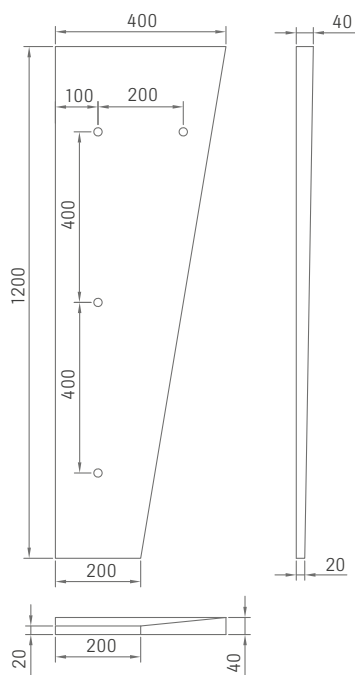

FreeStyle TR

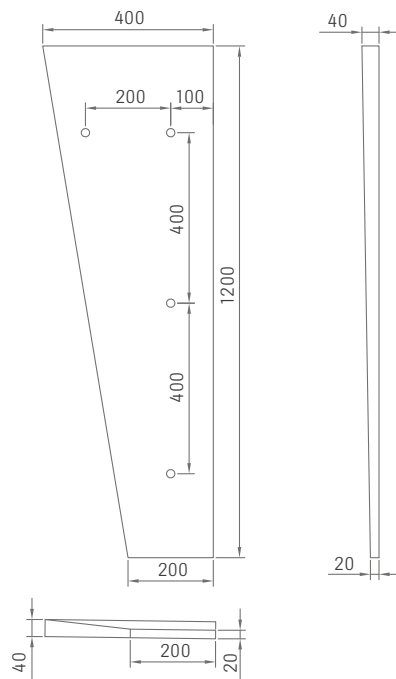

FreeStyle QS

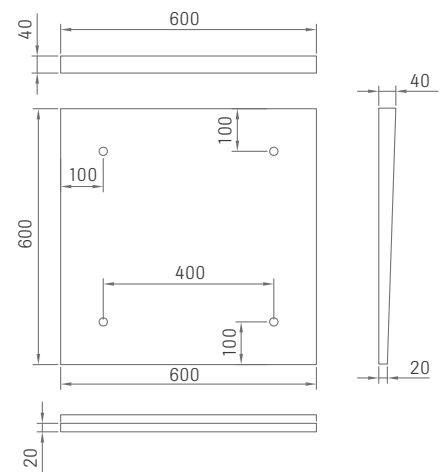

o = Marking for wall claw

Wall installation – FreeStyle

2. Level out any unevenness in the wall.
3. Measure and level the position of the wall claws according to the markings on the rear of the components.
4. Fasten wall claws with approved fixings according to the respective substrate.
5. Position the components on the wall claw and press on. Minor unevenness in the substrate can be evened out by applying different pressure.

If necessary, the components can be removed again and reinstalled at another location using the available wall claws.

Wall claws are **not** suitable for direct mounting on the ceiling!



Wall claw 88 x 52 x 1.0 mm, barbs 35 mm long

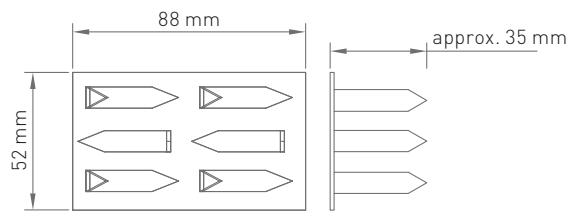

Wall claw for 40/20 mm strong wall absorber, claw height 15 mm

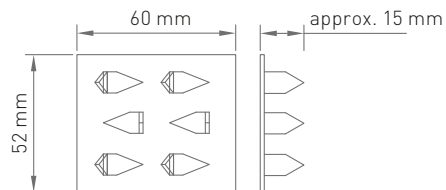



PRODUCT: Wall absorber – Corpus
PROJECT: Beckhoff Automation
REGION: Verl, Germany

Wall absorber **Corpus**

Classical styling - individual design freedom Corpus

Corpus, which has won several design awards, offers excellent acoustic performance in an expressive design. It is based on a modular system consisting of ten different rectangular and square acoustic cuboids with ultra-fine, white, fleece covered surfaces. The wall absorbers are quick and easy to install and offer limitless configuration options. Unique formations can be created to optimize their surroundings acoustically and generate design highlights in the room.





PRODUCT: Wall absorber – Corpus

PROJECT: Beckhoff Automation

REGION: Verl, Germany

Corpus

Corpus white fleece

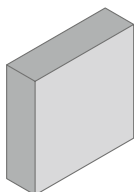

Corpus S1

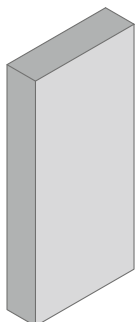

Corpus M1

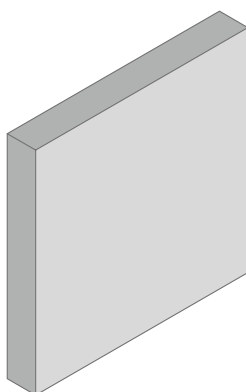

Corpus L1

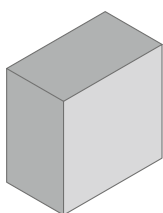

Corpus S2

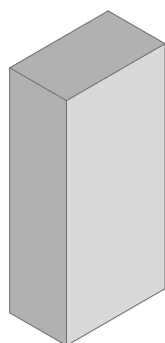

Corpus M2

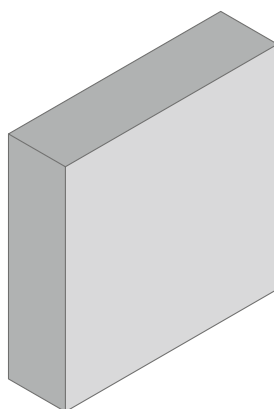

Corpus L2



For more information on articles and prices, please see the [OWAconsult collection price list 1001 e.](#)

Corpus

Corpus

| | Length | Width | Height | Thickness | Visible side | Weight | Part no. |
|-----------|---------|---------|--------|-----------|--------------|----------------|----------|
| Corpus S1 | 520 mm | 520 mm | 150 mm | 40 mm | white fleece | approx. 2.2 kg | 00074869 |
| Corpus S2 | 520 mm | 520 mm | 300 mm | 40 mm | white fleece | approx. 3.4 kg | 00074870 |
| Corpus M1 | 1120 mm | 520 mm | 150 mm | 40 mm | white fleece | approx. 4.1 kg | 00074871 |
| Corpus M2 | 1120 mm | 520 mm | 300 mm | 40 mm | white fleece | approx. 6.0 kg | 00074872 |
| Corpus L1 | 1120 mm | 1120 mm | 150 mm | 40 mm | white fleece | approx. 7.3 kg | 00074873 |
| Corpus L2 | 1120 mm | 1120 mm | 300 mm | 40 mm | white fleece | approx. 9.9 kg | 00074874 |

Packing unit for all wall absorbers: 1 piece per parcel | **Installation sets must be ordered separately and are not included in the price.**

Technical data at a glance

| | |
|----------------------------|--|
| Visible side | White fleece |
| Edges | White fleece |
| Edge detail | Straight edges, all the way round |
| Grid suspension | Inclusive packing unit for wall installation |
| Sound absorption | Sound absorption values, see page 51 |
| Humidity resistance | Up to 90 % RH |

Installation accessories – Corpus

| | Component description | Part no. |
|------------------|--|----------|
| Corpus S1 und S2 | 1 piece set set contains 4 pieces of wall claws (4 pieces are required for installation) | 00073602 |
| Corpus M1 und M2 | | |
| Corpus L1 und L2 | 2 piece set set contains 4 pieces of wall claws (6 pieces are required for installation) | 00073602 |

Please order **one** fitting set per canopy. **Installation sets must be ordered separately and are not included in the price.**



Wall claw 88 x 52 x 1.0 mm, barbs 35 mm long

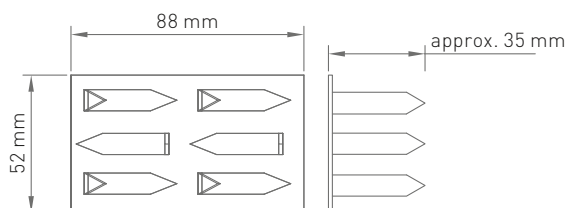

Wall installation – Corpus

1. Rear view of the wall absorbers:
Recommended fixing points for the wall claws.

Corpus S1/S2

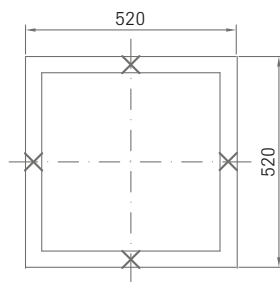

Rear view

Corpus M1/M2

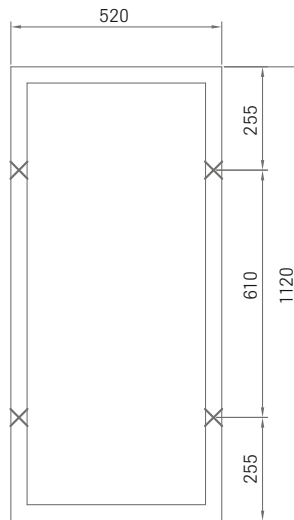

Rear view

Corpus L1/L2

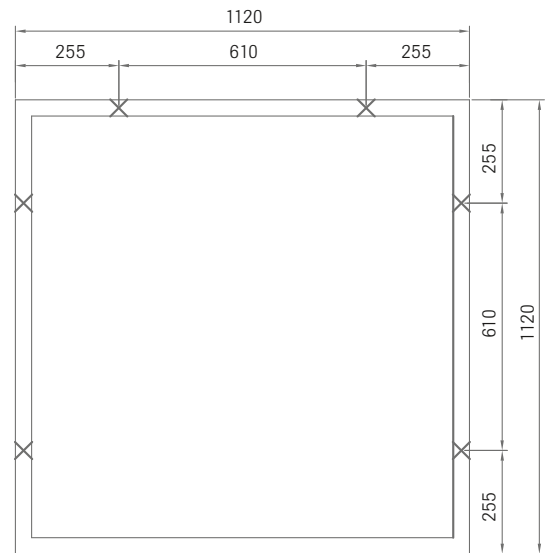

Rear view

Corpus S1

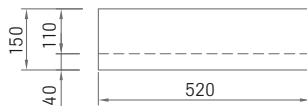

Corpus M1

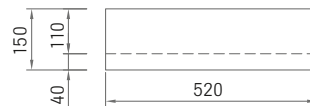

Corpus L1

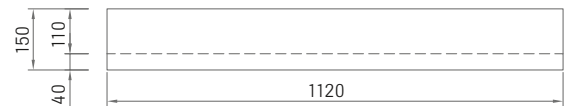

Corpus S2

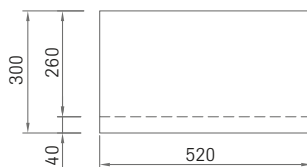

Corpus M2

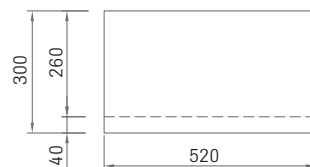

Corpus L2

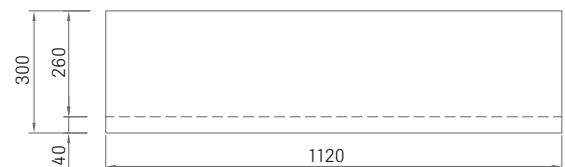

x = Wall claw fixing points

The distances between the fixing points must match the on-site setting out on the wall.

Wall installation – Corpus

2. Level out any unevenness in the wall.
3. Measure and level the position of the wall claws according to the markings on the rear of the components.
4. Fasten wall claws with approved fixings according to the respective substrate.
5. Position the components on the wall claw and press on. Minor unevenness in the substrate can be evened out by applying different pressure.

If necessary, the components can be removed again and reinstalled at another location using the available wall claws.

Wall claws are **not** suitable for direct mounting on the ceiling!



Wall claw 88 x 52 x 1.0 mm, barbs 35 mm long

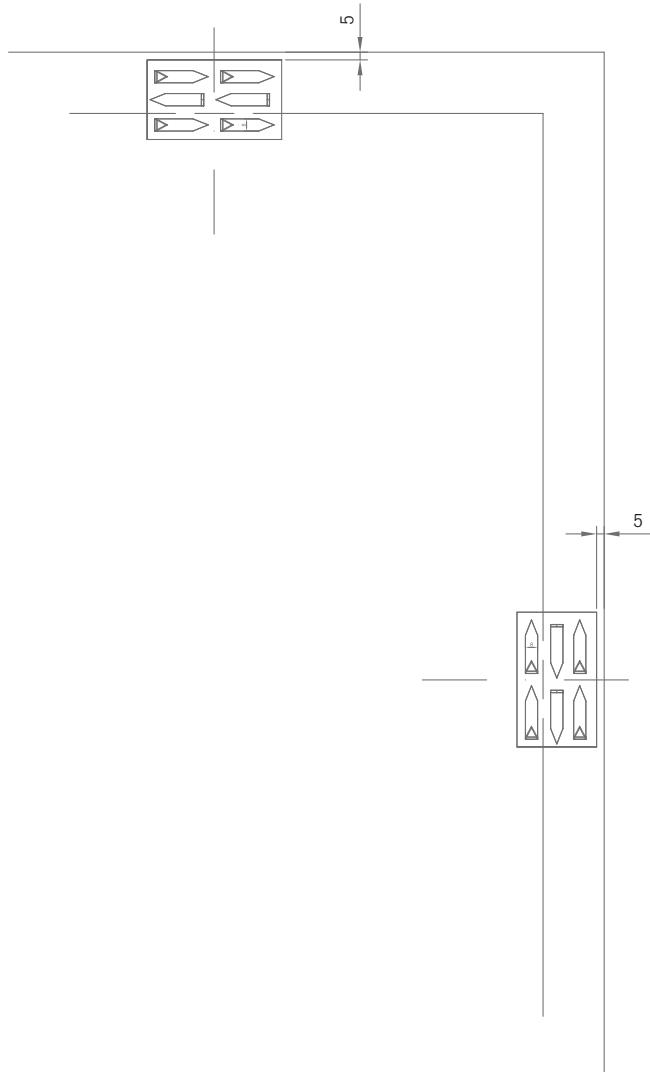
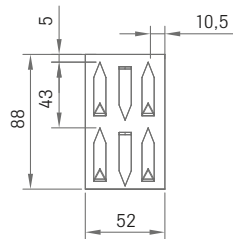



PRODUCT: Magnetic wall absorber – S 60

PROJECT: Merton school

REGION: Frankfurt, Germany

Magnetic wall absorber **OWAtecta S 60**

A different kind of wall design OWAtecta S 60

Acoustically effective wall surfaces can solve many different problems. The sound absorbing qualities of the magnetic wall absorber is excellently suited for optimising the reverberation time. Furthermore, bothersome reflections are avoided and flutter echoes suppressed. The number of magnetic wall absorbers can be customised to meet the requirements of the room acoustics.



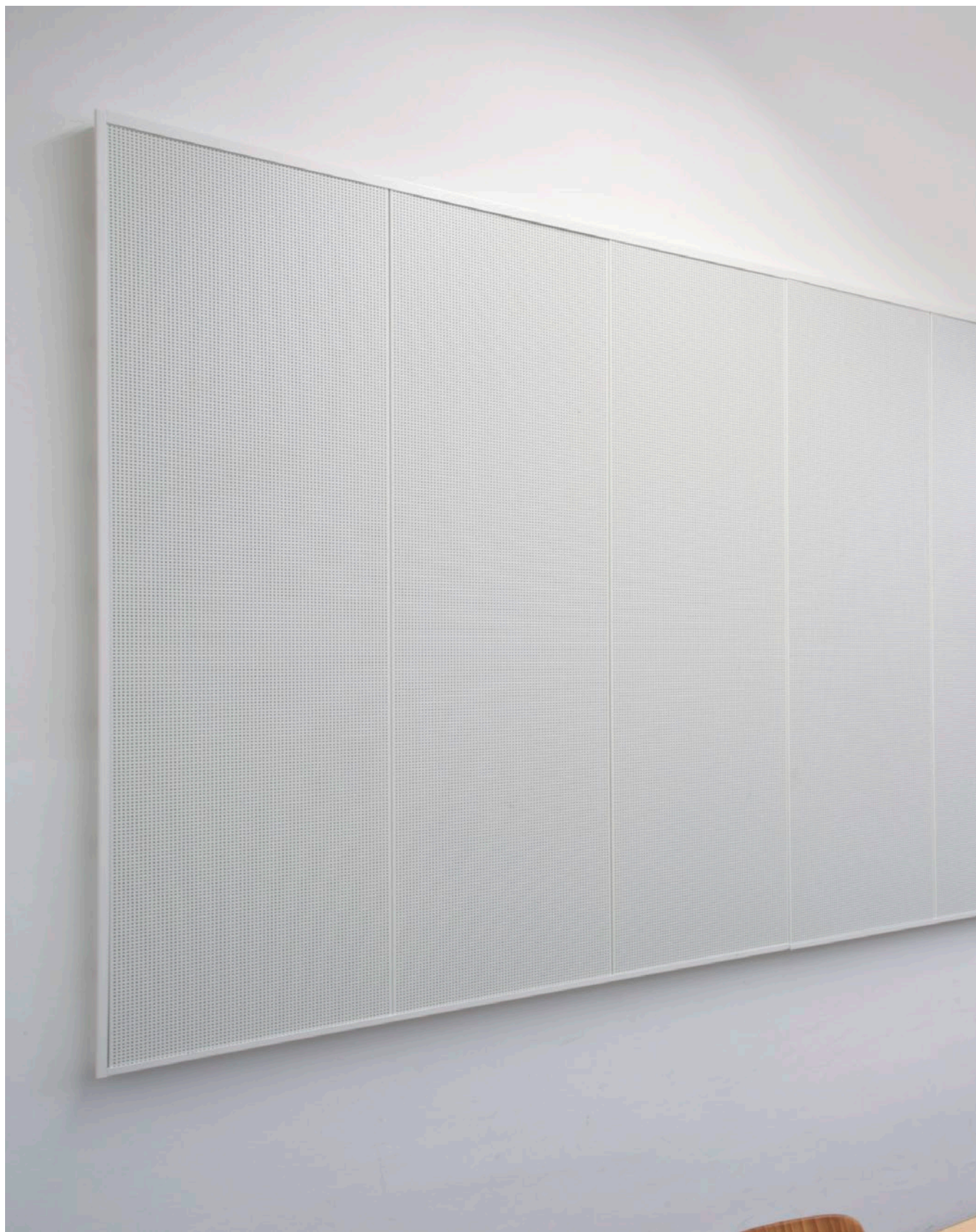

PRODUCT: Magnetic wall absorber – S 60

PROJECT: Merton school

REGION: Frankfurt, Germany

OWAtecta S 60

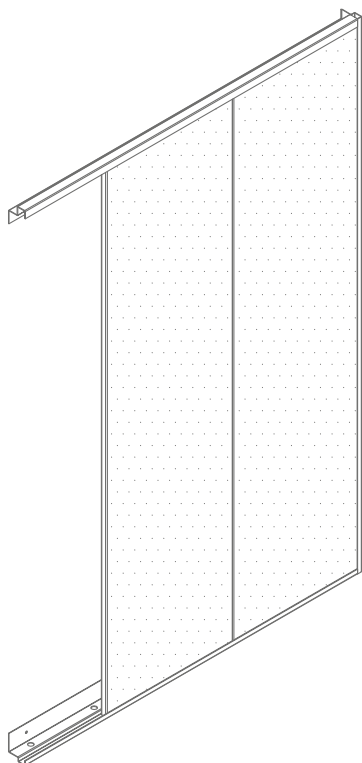

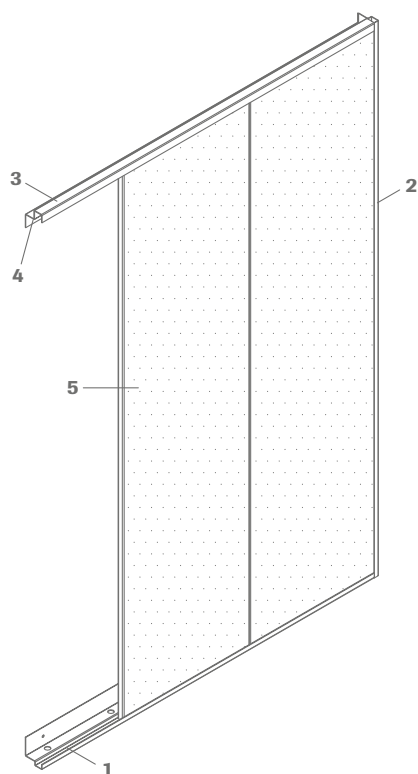

- 1 Frame profile, bottom, length: 1990 mm
- 2 Frame profile, side, length: 1518 mm
- 3 Frame profile, side, length: 1990 mm
- 4 Sealing tape
- 5 Single element

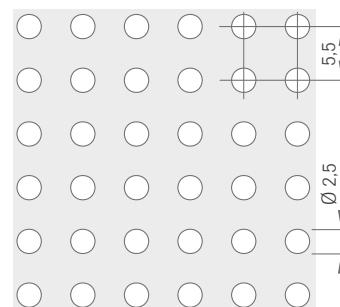

Rg2516 | Ø 2.5 mm
16 % open area

Wall absorber S 60

| | Length | Width | Thickness | Visible side | Perforation | Units | Part no. |
|------------------------------|---------|--------|-----------|-----------------------|-------------|-------|----------|
| Metal rectangular panel S 60 | 1500 mm | 400 mm | 18 | white, black fleece | Rg2516 | 5 | 00078515 |
| Mineral tile, MINOWA® | 1500 mm | 396 mm | 15 mm | sharp edge all around | embossed | 10 | 00057153 |

Technical data at a glance

| | |
|----------------------------|--|
| Dimensions | Standard overall size: overall length 2016 mm x overall height 1518 mm (extendable as required) Dimensions of individual sections: 1500 x 400 mm (other sizes on request) |
| Material | Metal tile frame: galvanized steel, perforated design with glued-in black acoustic fleece |
| Colour | White |
| Reaction to fire | Metal ceiling tile: A2-s1,d0 according to EN 13501-1 OWAcoustic mineral tile: A2-s1,d0 according to EN 13501-1 |
| Edges | Long edge 10 Short edge open |
| Thickness | Metal tile frame approx. 0.6 mm steel sheet Mineral tile approx. 15 mm (installation of mineral tiles in to metal frames is required on site) |
| Metal suspension | All metal components listed are galvanized steel or white coated galv. steel respectively |
| Sound absorption | Sound absorption values, see page 51 |
| Installation height | Approx. 53 mm from wall surface |

Installation accessories – OWAtecta S 60

Material requirement for an overall size of approx. (overall length 2016 mm x overall height 1518 mm)

| Description | Field length (extendable as required) | | |
|--|---------------------------------------|----------|----------|
| | 2000 mm | 4000 mm | 6000 mm |
| S 60 metal rectangular panel Rg2516 white, black fleece units: 5 pieces/pack, available for delivery from Amorbach warehouse | 5 pcs | 10 pcs | 15 pcs |
| Basic assembly for OWAtect S 60 a wall absorber consisting of: 2 pieces, frame profile, side (51.5/31.5/13/23/13.5 x 1518 mm) 1 piece, frame profile, top (37/29/25.5/25.5/21.5 x 1990 mm) 1 piece, frame profile, bottom (51.5/31.5/13/23/13.5 x 1990 mm), profile colour: white | 1 pce | 1 pce | 1 pce |
| Anthracite joint tape, self-adhesive on one side, roll 20 m | 1 roll | 1 roll | 1 roll |
| Mineral tile 10/P, thickness: 15 mm, A2-s1,d0, 1500 x 396 mm, sharp edge all around front: Harmony without primer, back: without primer | 10 Stück | 10 Stück | 20 Stück |
| Extension assembly for OWAtect S 60 a wall absorber consisting of: 1 piece, frame profile, top (37/29/25.5/25.5/21.5 x 2000 mm) 1 piece, frame profile, bottom (51.5/31.5/13/23/13.5 x 2000 mm), profile colour: white | – | 1 pce | 2 pcs |

Please note: purchases only available in complete packs or assemblies.

Wall perimeters

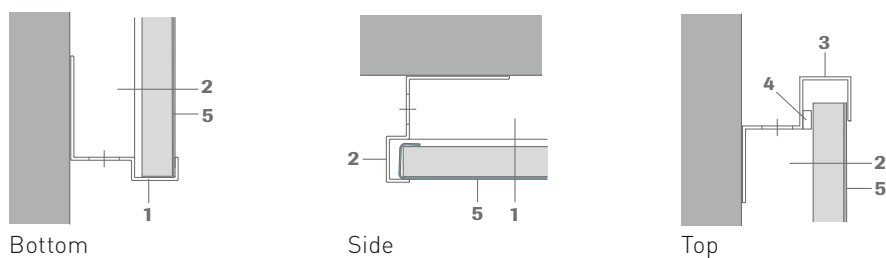

For more information on installation see [OWAtecta install guide 9303 e.](#)

Example of standard installation:

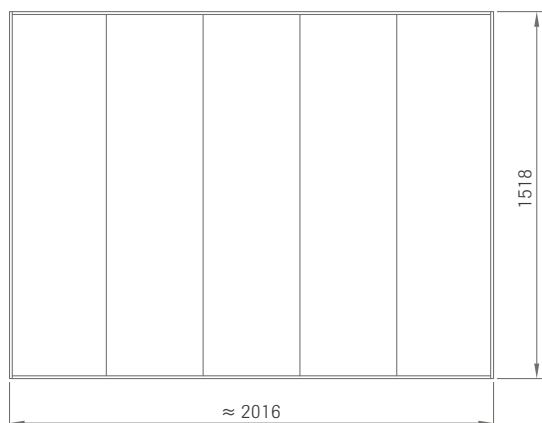

Note:

The length of the magnetic wall absorber being used is dependent on the room acoustics that are to be achieved. The total installation can be expanded in 0.4 m increments. The bottom and top angles must be adapted on site.

Section

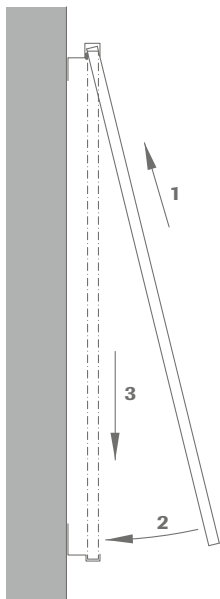

Installation and removal of the sections

Before positioning the OWAtecta sections, they must be fitted with the OWAcoustic mineral tiles provided.

Please note:

The total surface of the magnetic wall absorber may only be covered by up to 1/3. Greater covering of the surface reduces the improvement in reverberation time.

Acoustically effective wall surfaces can solve many different problems. The sound absorbing qualities of the magnetic pin board wall absorber is excellently suited for:

- optimising the reverberation time
- avoiding bothersome reflections
- suppression of flutter echoes

Cross section

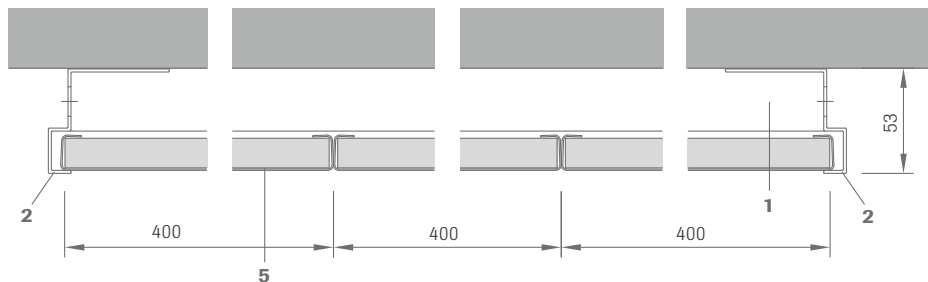

Sound absorption figures overview

Selecta. Creaprint. Curve

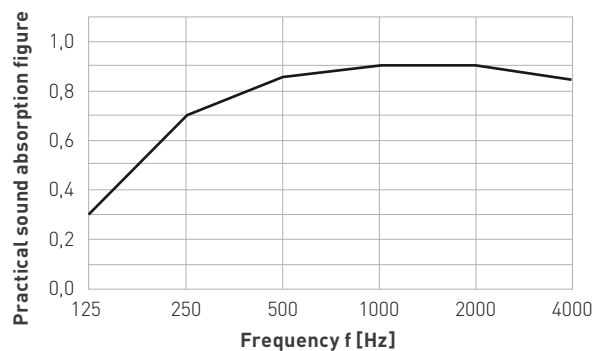

| Freq. [Hz] | α_p |
|------------|------------|
| 125 | 0.30 |
| 250 | 0.70 |
| 500 | 0.85 |
| 1000 | 0.90 |
| 2000 | 0.90 |
| 4000 | 0.85 |
| α_w | 0.90 |
| NRC | 0.85 |

FreeStyle

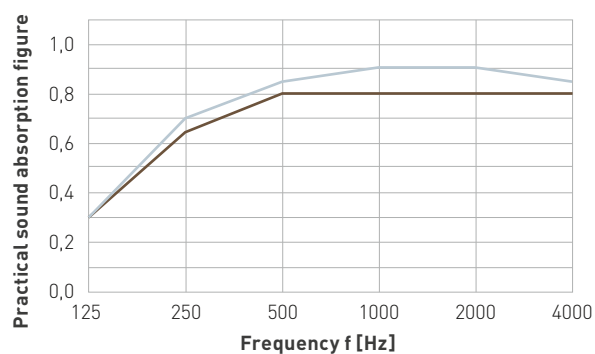

| Freq. [Hz] | FreeStyle TR/TL/QS (20/40 mm) α_p | FreeStyle R/Q (40 mm) α_p |
|------------|--|----------------------------------|
| 125 | 0.30 | 0.30 |
| 250 | 0.65 | 0.70 |
| 500 | 0.80 | 0.85 |
| 1000 | 0.80 | 0.90 |
| 2000 | 0.80 | 0.90 |
| 4000 | 0.80 | 0.85 |
| α_w | 0.80 | 0.90 |
| NRC | 0.80 | 0.85 |

Corpus

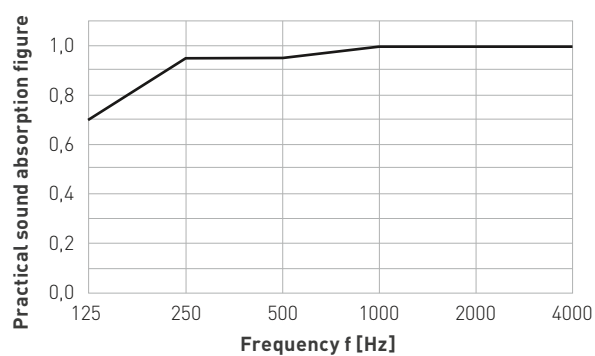

| Freq. [Hz] | α_p |
|------------|------------|
| 125 | 0.70 |
| 250 | 0.95 |
| 500 | 0.95 |
| 1000 | 1.00 |
| 2000 | 1.00 |
| 4000 | 1.00 |
| α_w | 1.00 |
| NRC | 1.00 |

S 60

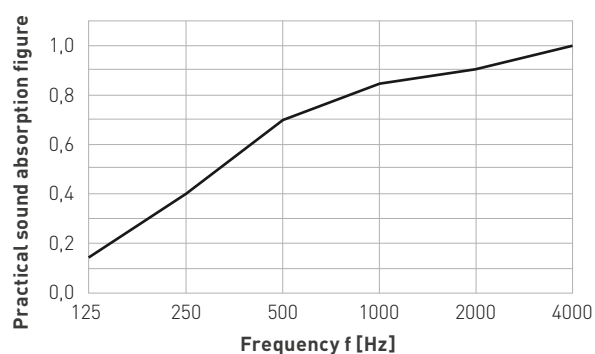

| Freq. [Hz] | α_p |
|------------|------------|
| 125 | 0.15 |
| 250 | 0.40 |
| 500 | 0.70 |
| 1000 | 0.85 |
| 2000 | 0.90 |
| 4000 | 1.00 |
| α_w | 0.70 |
| NRC | 0.70 |

OWAcolour - fabric colour options



52826 | Dark red

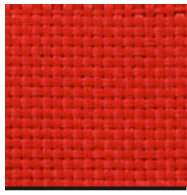

52827 | Red

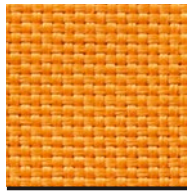

52828 | Orange



52829 | Dark brown



52830 | Black



52831 | Dark grey

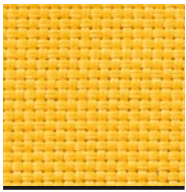

52832 | Yellow



52833 | Green-grey



52834 | Light grey

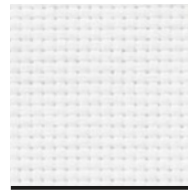

52835 | White



52836 | Light beige



52837 | Medium brown



52838 | Mottled brown



52839 | Grey

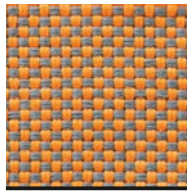

52840 | Mottled orange

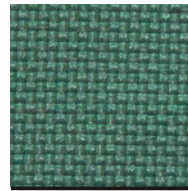

52841 | Petrol

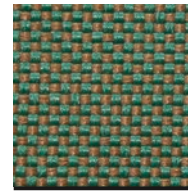

52842 | Mottled green



52843 | Blue

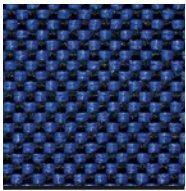

52844 | Midnight blue

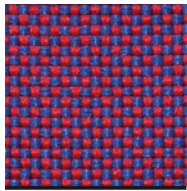

52845 | Violet

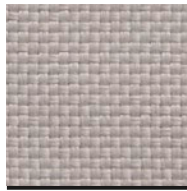

55244 | Stone grey



55245 | Olive green

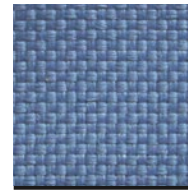

55246 | Light blue



55247 | Mint green

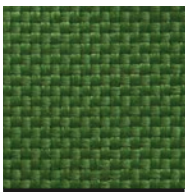

55248 | Dark green



55249 | Grey-blue

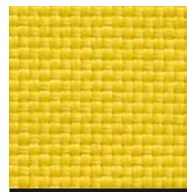

55250 | Light yellow

Technical specifications

| | |
|--------------------|------------------------------|
| Composition | 100 % polyester, FR ATY yarn |
| Weave | Panama |
| Weight | 320 g/m ² |
| Width | 1500 mm (+/- 50 mm) |

www.owa-ceilings.com



Certified Management Systems

Odenwald Faserplattenwerk GmbH

Dr.-F.-A.-Freundt-Straße 3 | 63916 Amorbach | Germany
tel +49 9373 201-0 | info@owa.de
www.owa-ceilings.com

The information in this brochure is up-to-date at the time of publication. Subject to alterations. Please contact our competence team OWAconsult for specific advice. Our experts will be happy to answer your questions under the following contact details: tel: +49 9373 201-444 or e-mail: info@owaconsult.de